



Lochinvar[®]
HIGH EFFICIENCY BOILERS & WATER HEATERS

**Solar Brazed-Plate
Heat Exchanger
Submittal Sheet**

SBP-Sub-03

SOLAR BRAZED-PLATE HEAT EXCHANGER

JOB NAME _____

LOCATION _____

ENGINEER _____

WHOLESALER _____

MECH. CONTRACTOR _____

MODEL NO. _____

NOTES

Standard Features

- › 316L Stainless Steel Plates
- › 304L Stainless Steel Connectors
- › UL Listed
- › 450 PSI Max Working Pressure (Single Wall)
- › 350°F Max Working Temperature (Single Wall)
- › 653 PSI Max Working Pressure (Double Wall)
- › 392°F Max Working Temperature (Double Wall)

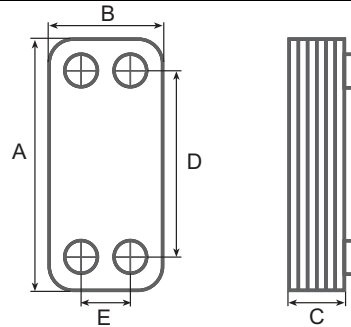

Model Number	A	B	C	D	E	Connection Size	Collector Area Covered Ft ²	Weight (.lbs)
Single Wall								
HEX20025	12-3/4"	3-1/2"	1-1/2"	11"	1-3/4"	3/4"	107	5
HEX20026	12-3/4"	3-1/2"	2"	11"	1-3/4"	3/4"	215	6
HEX20027	12-3/4"	3-1/2"	2-1/2"	11"	1-3/4"	3/4"	323	7
HEX20028	12-3/4"	3-1/2"	4"	11"	1-3/4"	3/4"	538	10
HEX20029	21"	5"	4"	18-3/4"	3"	1"	861	25
HEX20030	21"	5"	4-3/4"	18-3/4"	3"	1-1/4"	1076	30
HEX20031	21"	5"	9-1/4"	18-3/4"	3"	1-1/4"	2153	54
HEX20032	21-1/2"	11"	5-3/4"	18"	7-3/4"	2"	3229	84
HEX20033	21-1/2"	11"	8-3/4"	18"	7-3/4"	2-1/2"	5382	117
Double Wall								
HEX20071	13-1/4"	5"	1-1/2"	11"	3"	1"	107	7
HEX20072	13-1/4"	5"	2-1/2"	11"	3"	1"	215	10
HEX20073	13-1/4"	5"	2-3/4"	11"	3"	1"	323	11
HEX20074	13-1/4"	5"	4-1/4"	11"	3"	1"	538	15
HEX20075	21"	5"	5-1/4"	19"	3"	1-1/4"	861	34
HEX20076	21"	5"	7"	19"	3"	1-1/4"	1076	46
HEX20077	21"	5"	8"	19"	3"	1-1/4"	1614	52
HEX20078	21"	5"	12"	19"	3"	1-1/4"	2691	76

NOTE: All water connections are NPT.



Lochinvar[®]
HIGH EFFICIENCY BOILERS & WATER HEATERS

Lochinvar, LLC
300 Maddox Simpson Parkway
Lebanon, Tennessee 37090
P: 615.889.8900 / F: 615.547.1000
www.Lochinvar.com

