

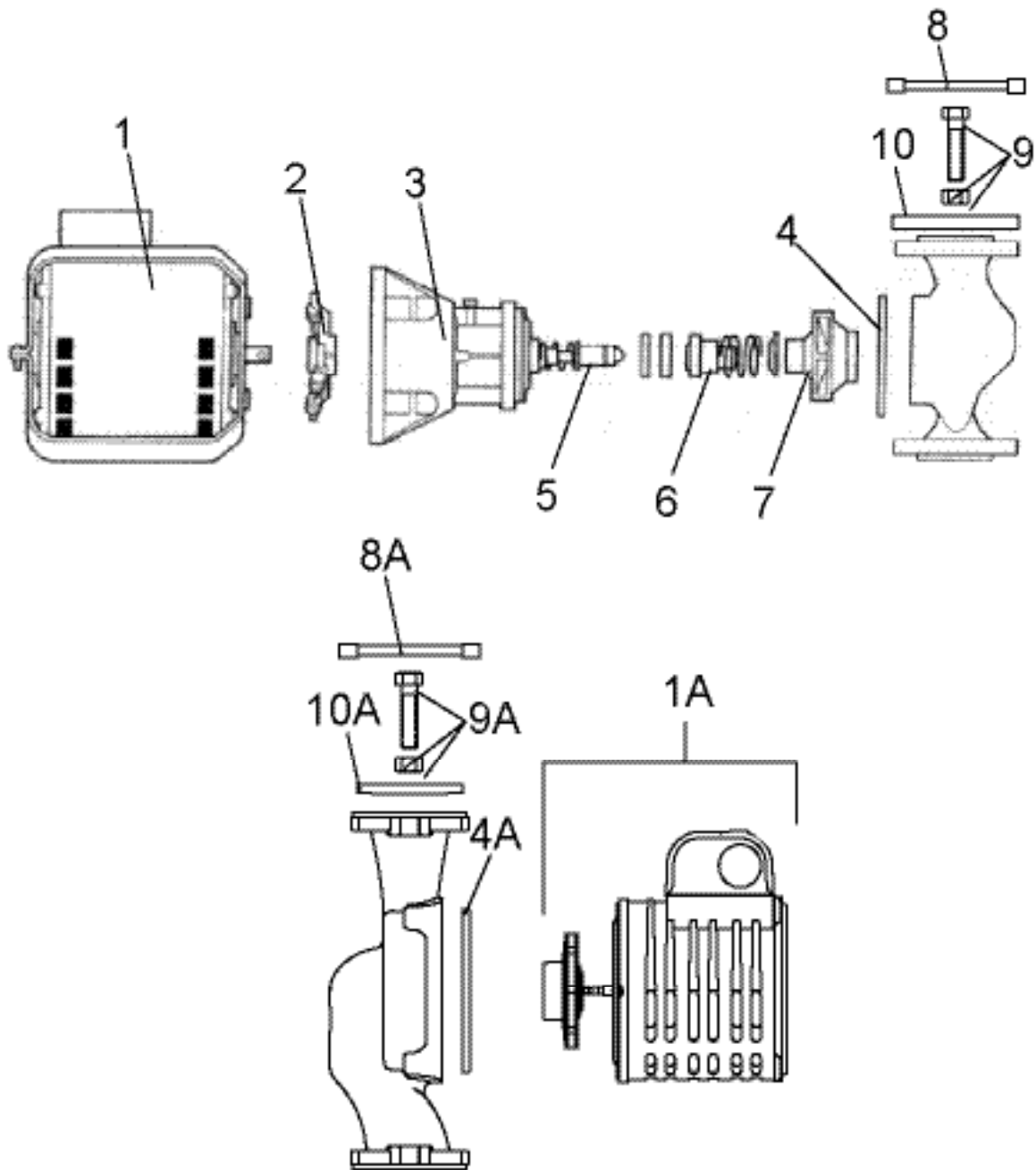

Replacement Parts List

PARTS & SERVICE DEPARTMENT
Nashville, Tennessee
615-889-8900 • Fax: 615-882-2918
parts_team@lochinvar.com
www.Lochinvar.com

CIRCULATING PUMPS for Domestic Hot Water



CW(N,L) 495-745 , EW(N,L)150-300 , CF(N,L)401-751			100133610 / 100133612 1/4 HP
ITEM NO.	PART NUMBER	DESCRIPTION	
1	100276785	MOTOR	
2	100278231	COUPLER	
3	100277747	SEAL BEARING ASSEMBLY	
4	100327114	VOLUTE GASKET	
5	100277757	BEARING MODULE	
6	100327033	SEAL KIT	
7	100277784	IMPELLER	
8	100327311	FLANGE PAB - 2" (REQ. 2)	
8	100337690	FLANGE PBF - 2" (REQ. 2)	
9	100327186	BOLT & GASKET KIT	
10	100327057	FLANGE GASKET	
CP(N,L)401-751, CS(N,L)495-745			100133611 1/4 HP
ITEM NO.	PART NUMBER	DESCRIPTION	
1	100337701	MOTOR	
2	100278231	COUPLER	
3	100277747	SEAL BEARING ASSEMBLY	
4	100327114	VOLUTE GASKET	
5	100277757	BEARING MODULE	
6	100327033	SEAL KIT	
7	100277784	IMPELLER	
8	100327311	FLANGE - 2" (REQ. 2)	
9	100327186	BOLT & GASKET KIT	
10	100327057	FLANGE GASKET	
CF(N,L) 991-2071 & 990-2070 , CW(N,L) 986-2066 & 985-2065			100133601 / 100133603 1/2 HP
ITEM NO.	PART NUMBER	DESCRIPTION	
1	100278143	MOTOR	
2	100327308	COUPLER	
3	100278131	SEAL BEARING ASSEMBLY	
4	100277953	VOLUTE GASKET	
5	100277757	BEARING MODULE	
6	100327033	SEAL KIT	
7	100277758	IMPELLER	
8	100208244	FLANGE PAB - 2.5" (REQ. 2)	
8	100278097	FLANGE PBF - 2.5" (REQ. 2)	
9	100337702	BOLT & GASKET KIT	
10	100337710	FLANGE GASKET	
CP(N,L) 991-1441 & 990-2070, CS(N,L)985-2065			100133602 1/2 HP
ITEM NO.	PART NUMBER	DESCRIPTION	
1	100276817	MOTOR	
2	100327308	COUPLER	
3	100278131	SEAL BEARING ASSEMBLY	
4	100277953	VOLUTE GASKET	
5	100277757	BEARING MODULE	
6	100327033	SEAL KIT	
7	100277758	IMPELLER	
8	100208244	FLANGE - 2.5" (REQ. 2)	
9	100337709	BOLT & GASKET KIT	
10	100337710	FLANGE GASKET	
CP(N,L) 1801-2071			100133617 3/4 HP
ITEM NO.	PART NUMBER	DESCRIPTION	
1	100133589	MOTOR	
2	100327308	COUPLER	
3	100278131	SEAL BEARING ASSEMBLY	
4	100277953	VOLUTE GASKET	
5	100277757	BEARING MODULE	
6	100327033	SEAL KIT	
7	100327345	IMPELLER	
8	100208244	FLANGE - 2.5" (REQ. 2)	
9	100337702	BOLT & GASKET KIT	
10	100337710	FLANGE GASKET	

PLEASE HAVE MODEL AND SERIAL NUMBER WHEN ORDERING PARTS

PF(N,L)250-1000 BEFORE A05H00172528			100133599 / 100133600 1/2 HP
ITEM NO.	PART NUMBER	DESCRIPTION	
1	100337763	MOTOR	
2	100327308	COUPLER	
3	100278131	SEAL BEARING ASSEMBLY	
4	100277953	VOLUTE GASKET	
5	100277757	BEARING MODULE	
6	100327033	SEAL KIT	
7	100277758	IMPELLER	
8	100327312	FLANGE PAB - 2" (REQ. 2)	
8	100337706	FLANGE PBF - 2" (REQ. 2)	
9	100329664	BOLT & GASKET KIT	
10	100337710	FLANGE GASKET	
PF(N,L)501 A05H00172528 & AFTER			100166429 2/5 HP
PF(N,L)502 - 1302			100166433 2/5 HP
ITEM NO.	PART NUMBER	DESCRIPTION	
1A	100278069	PUMP LESS VOLUTE	
4A	100327322	VOLUTE GASKET	
8A	100327312	FLANGE - 2" (REQ. 2)	
9A	100329664	BOLT & GASKET KIT	
10A	100337710	FLANGE GASKET	
PF(N,L)751-1300 A05H00172528 & AFTER			100133605 1/2 HP
ITEM NO.	PART NUMBER	DESCRIPTION	
1	100337764	MOTOR	
2	100327308	COUPLER	
3	100278131	SEAL BEARING ASSEMBLY	
4	100277953	VOLUTE GASKET	
5	100277757	BEARING MODULE	
6	100327033	SEAL KIT	
7	100277758	IMPELLER	
8	100208244	FLANGE - 2.5" (REQ. 2)	
9	100337709	BOLT & GASKET KIT	
10	100337710	FLANGE GASKET	
PF(N,L)1501-2001 & 1500-2000			100133622 / 100133623 3/4 HP
ITEM NO.	PART NUMBER	DESCRIPTION	
1	100337708	MOTOR	
2	100327308	COUPLER	
3	100278131	SEAL BEARING ASSEMBLY	
4	100277953	VOLUTE GASKET	
5	100277757	BEARING MODULE	
6	100327033	SEAL KIT	
7	100327345	IMPELLER	
8	100208244	FLANGE PAB & PBF - 2.5" (REQ. 2)	
9	100337709	BOLT & GASKET KIT	
10	100337710	FLANGE GASKET	
CW2620-M9 & CWN3080-M9-100			100133606 / 100133607 1/3 HP
ITEM NO.	PART NUMBER	DESCRIPTION	
1	100278144	MOTOR	
2	100278231	COUPLER	
3	100277747	SEAL BEARING ASSEMBLY	
4	100327114	VOLUTE GASKET	
5	100277757	BEARING MODULE	
6	100327033	SEAL KIT	
7	100337766	IMPELLER	
8	100337767	FLANGE PAB - 3" (REQ. 2)	
8	100337768	FLANGE PBF - 3" (REQ. 2)	
9	100337769	BOLT & GASKET KIT	
10	100327057	FLANGE GASKET	

PLEASE HAVE MODEL AND SERIAL NUMBER WHEN ORDERING PARTS

ITEM NO.	PART NUMBER	DESCRIPTION
1A	100337703	PUMP LESS VOLUTE
4A	100327322	VOLUTE GASKET
8A	100337704	FLANGE PAB - 1.5" (REQ. 2)
8A	100337705	FLANGE PBF - 1.5" (REQ. 2)
9A	100337720	BOLT & GASKET KIT
10A	100327040	FLANGE GASKET

EP150-300

100133620 / 100133621 1/6 HP

ITEM NO.	PART NUMBER	DESCRIPTION
1A	100277764	PUMP LESS VOLUTE
4A	100327322	VOLUTE GASKET
8A	100327312	FLANGE PAB - 2" (REQ. 2)
8A	100337706	FLANGE PBF - 2" (REQ. 2)
9A	100329664	BOLT & GASKET KIT
10A	100337707	FLANGE GASKET

IB-IW(N,L)1500-2000

100133615 / 100133618 3/4 HP

ITEM NO.	PART NUMBER	DESCRIPTION
1	100337708	MOTOR
2	100327308	COUPLER
3	100278131	SEAL BEARING ASSEMBLY
4	100277953	VOLUTE GASKET
5	100277757	BEARING MODULE
6	100327033	SEAL KIT
7	100327345	IMPELLER
8	100208244	FLANGE PAB & PBF - 2.5" (REQ. 2)
9	100337709	BOLT & GASKET KIT
10	100337710	FLANGE GASKET

AW150-199

100166430 1/6 HP

ITEM NO.	PART NUMBER	DESCRIPTION
1A	100337711	PUMP LESS VOLUTE
4A	100327322	VOLUTE GASKET
8A	100337712	FLANGE - 1.25" (REQ. 2)
9A	100337713	BOLT & GASKET KIT
10A	100337717	FLANGE GASKET

AW285

100166431 2/5 HP

ITEM NO.	PART NUMBER	DESCRIPTION
1A	100166327	PUMP LESS VOLUTE
4A	100327322	VOLUTE GASKET
8A	100208245	FLANGE - 2" (REQ. 2)
9A	100337713	BOLT & GASKET KIT
10A	100337717	FLANGE GASKET
-	100337719	PUMP FLANGE AND HARDWARE KIT USED PRIOR TO C08

AW399

100166432 2/5 HP

ITEM NO.	PART NUMBER	DESCRIPTION
1A	100337718	PUMP LESS VOLUTE
4A	100327322	VOLUTE GASKET
8A	100208245	FLANGE - 2" (REQ. 2)
9A	100337720	BOLT & GASKET KIT
10A	100327040	FLANGE GASKET
-	100337761	PUMP FLANGE AND HARDWARE KIT USED PRIOR TO C08

AW500-600

100166408 2/5 HP

ITEM NO.	PART NUMBER	DESCRIPTION
1A	100337762	PUMP LESS VOLUTE
4A	100327322	VOLUTE GASKET
8A	100208245	FLANGE - 2" (REQ. 2)
9A	100337720	BOLT & GASKET KIT
10A	100327040	FLANGE GASKET

PLEASE HAVE MODEL AND SERIAL NUMBER WHEN ORDERING PARTS